

Post – April 30, 2022 - Workshop #2

Orange Memorial Park Aquatic Center

A New Community Resource for

*The City of South San Francisco
May 5, 2022*



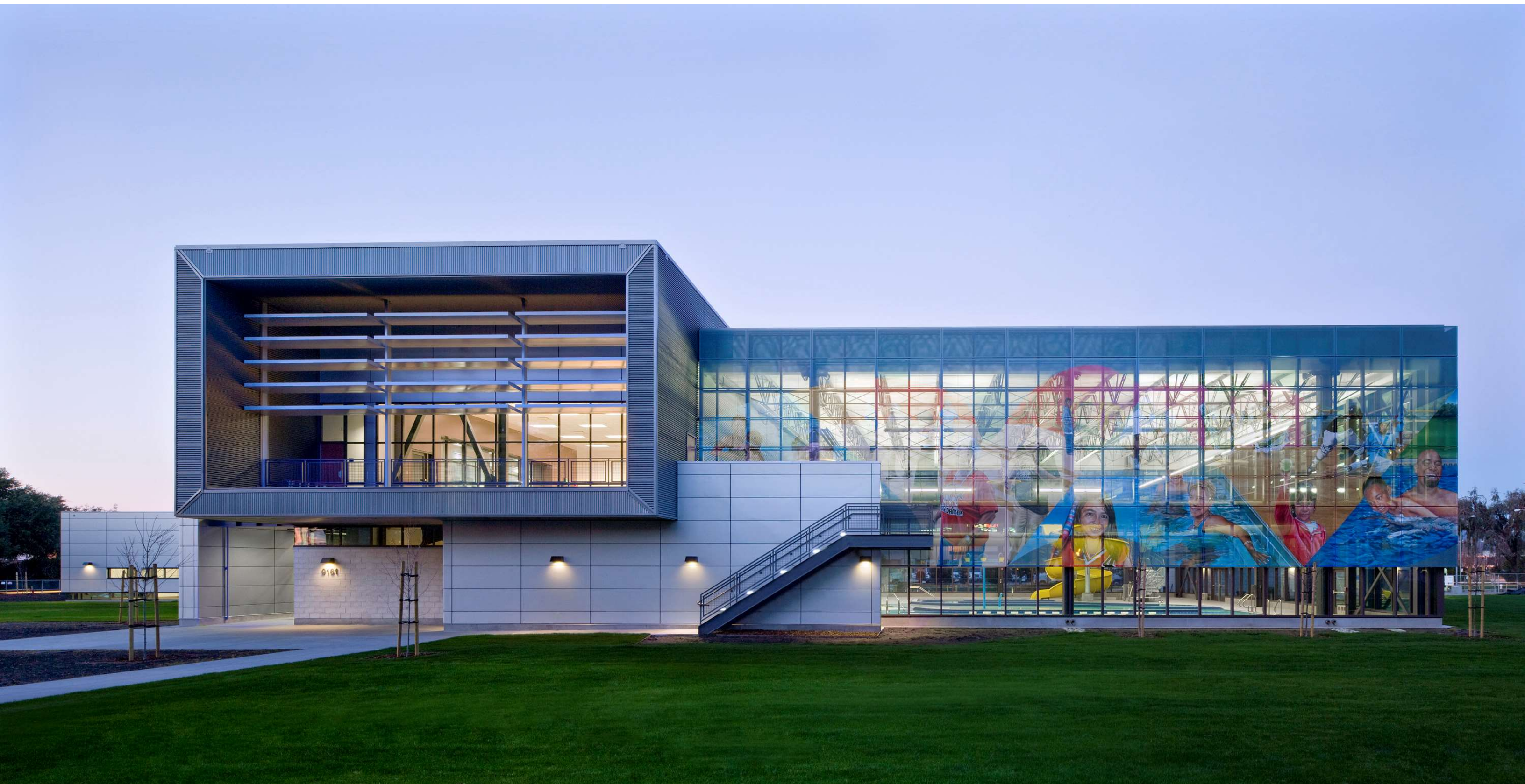



els/

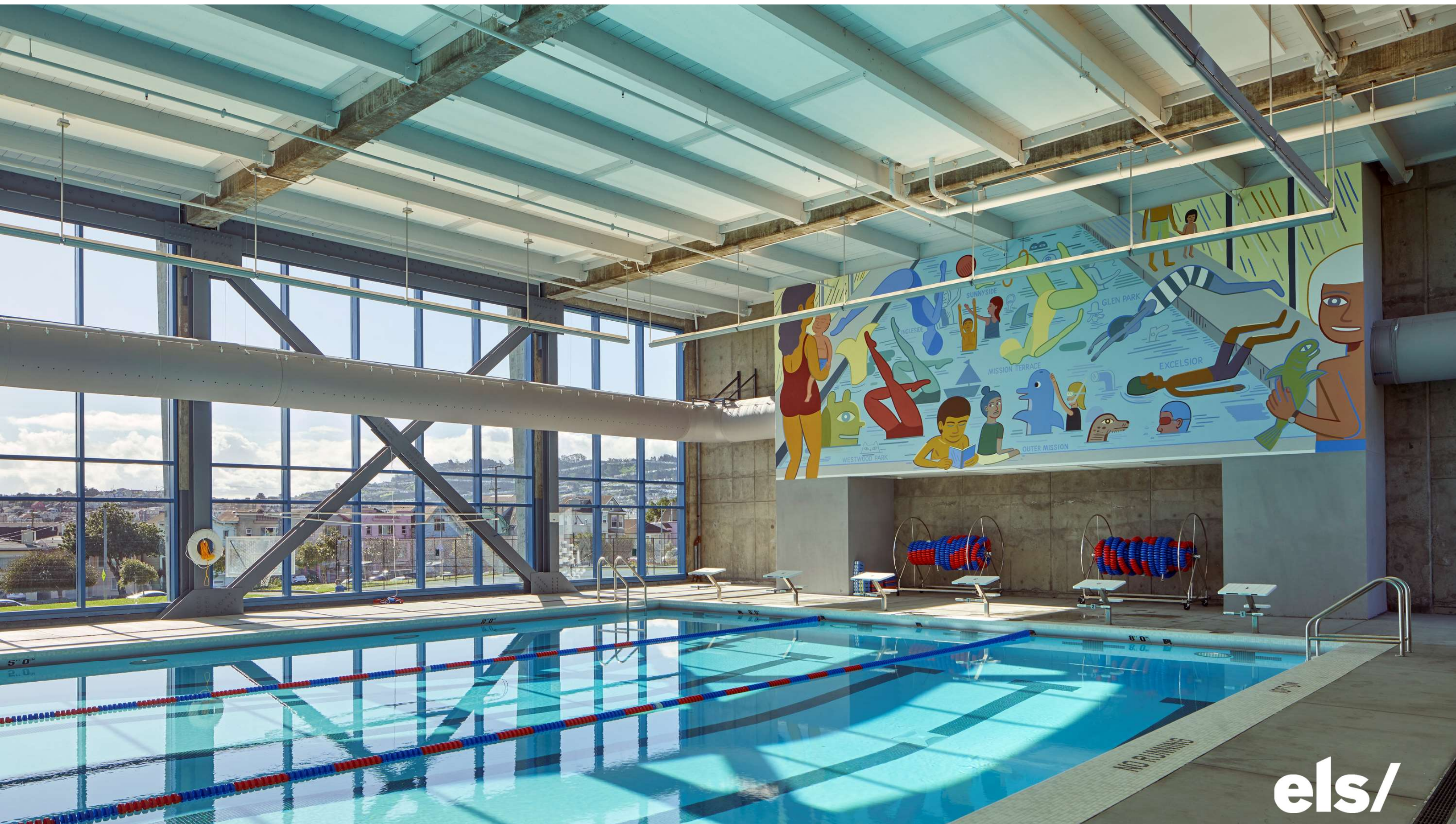

els/



els/

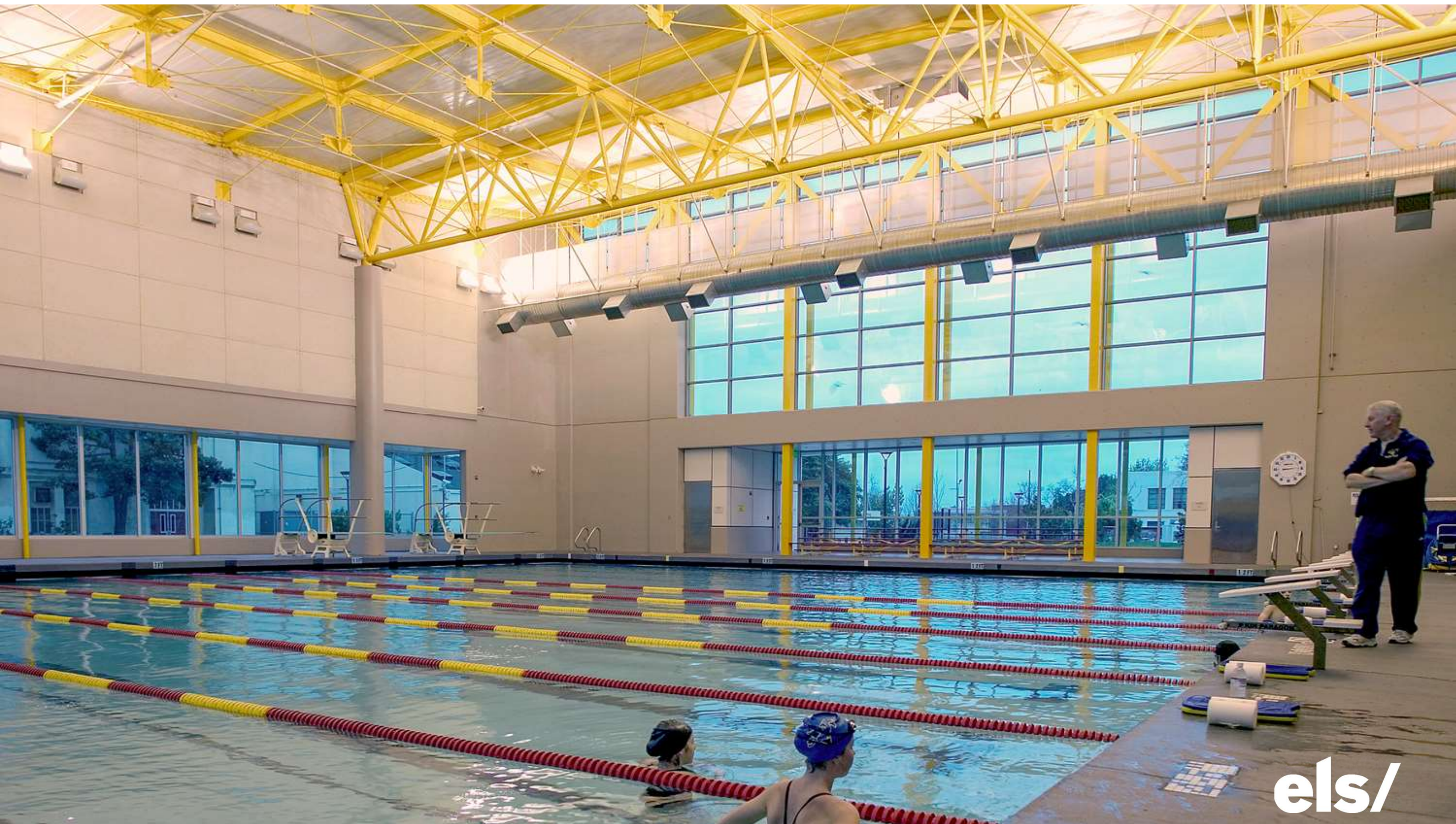

els/



els/

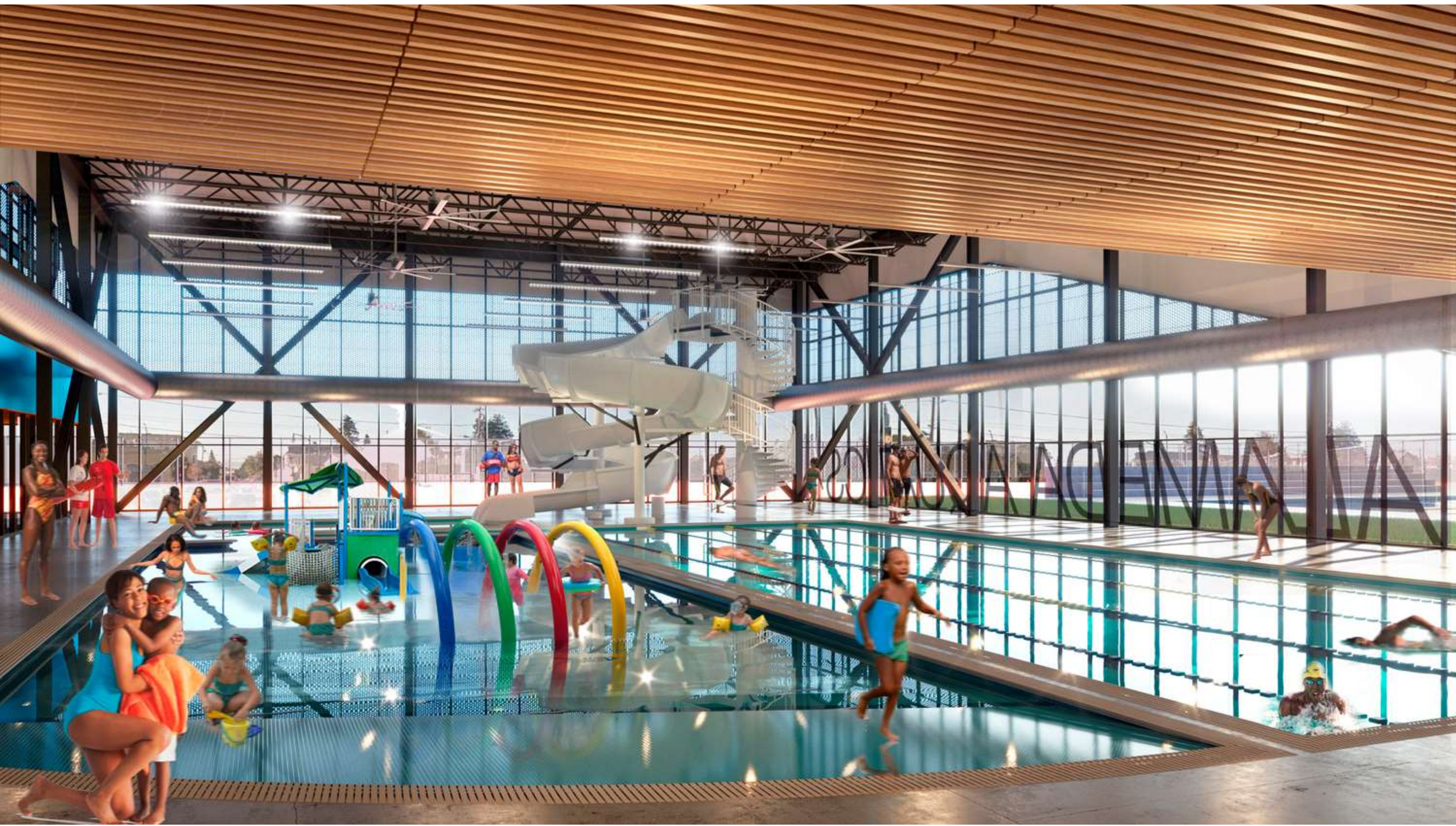

Welcome!

Orange Memorial Park Pool Workshop Series – Workshop #1

Orange Memorial Park Aquatic Center

A New Community Resource for

*The City of South San Francisco
April 30, 2022*



els/

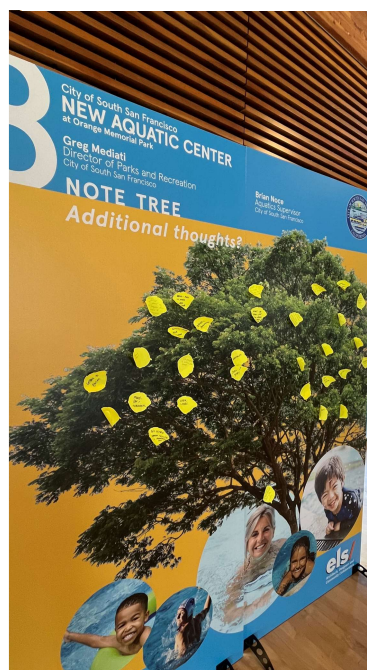

Welcome!

Orange Memorial Park Pool Workshop Series – Workshop #1



Orange Memorial Park
Aquatic Center
els/

Welcome!

Orange Memorial Park Pool Workshop Series – Workshop #1

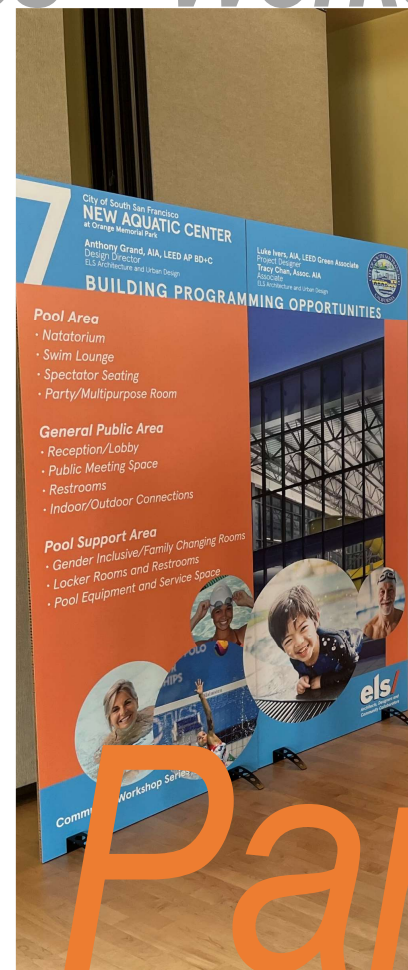

Orange Memorial Park
Aquatic Center
els/

Orange Memorial Park Aquatic Center: Workshop #1 Comments/Feedback															
Fast Water Pool	Warm Water Pool	General Pools	50m Pool	Locker Rooms	Pool Deck	Building	Competition/sports	Seniors	ADA/Special Needs	Swim Lessons	Connection to Park	LEED/Cal Green	WELL	Operations	Examples
<p>People who go to the pool in the morning think it's very crowded. I propose a bigger pool than existing (existing pool have 8 lanes and they were 25 ft deep).</p>	<p>The pool needed a lot for physical therapy</p>	<p>Thinking of resurfacing pool with plaster. Resurfacing changes the depths</p>	<p>hopes for Olympic sized pool 25 SF, and there's enough space in Orange Memorial Park</p>	<p>Wet-dry station is critical</p>	<p>Deck showers are a great amenity for people. People don't even want to go into the locker rooms, so they can shower on deck, towel dry, and leave</p>	<p>"artistic elements" i.e. industrial glass, sculptures, concrete or ceramic tile, lighting, etc. for a building that is elevated and inspirational. Likes modern architecture</p>	<p>Could meet current pool</p>	<p>For older people, current pool is too small. Pacific Burlingame for water aerobics</p>	<p>Stairs in the pool are difficult to use (people with low upper-body strength/mobility)</p>	<p>There should be year round lessons</p>	<p>Interested in more seating in the park, for picnicking, people- and nature-watching, and socializing</p>	<p>Provide PV system with battery storage and wind energy to supplement the PV.</p>	<p>Positive standard of coverage</p>	<p>One-year membership with unlimited swim</p>	<p>San Ramon pool is a good example – having an outdoor area is nice as well</p>
<p>People who go to the pool after work (afternoon) think that the pool feels crowded. I propose the pool should be shared over many programs/ classes. People often run into each other in the lanes.</p>	<p>Little kids should have a separate pool</p>	<p>Would like pool that can be open all day.</p>	<p>Interested in Olympic size pool</p>	<p>Women use the restroom. Changing long lines of people waiting to change or use the toilets</p>	<p>Pool deck surface should be durable – a lot of indoor pools end up putting mats on top of the deck but that's only a temporary solution</p>	<p>Would like to see artful design for the building. (Artistic representation: Industrial glass, ceramics, sculptures standing / wall décor)</p>	<p>Little pool could be 6 lanes x 25 yds for warm up/warm down</p>	<p>Elders love the warm water pools</p>	<p>Hope that it can be a suitable facility for weekly training for "developmental swimmers" which are those who participate/training for the special Olympics</p>	<p>Lessons need to be kept affordable</p>	<p>Interested in reservable rentable picnic clusters, say 2 tables plus a BBQ, adjacent to the pool, for birthday parties</p>		<p>Clean air location during fires.</p>	<p>Increase available lap time</p>	<p>La Petite Baleen Swim Schools are a good reference for pools from a lessons standpoint. Presidio as an example.</p>
<p>Add Diving board.</p>	<p>Would like toddler pool with water slides.</p>	<p>Preference for indoor pool</p>	<p>Needs to be a 50M indoor pool to host competitions</p>	<p>There are not enough shower stalls. Especially at peak times in adult swim hour</p>	<p>Concern there is not enough deck space and bleacher space</p>	<p>Indoor pool needs good ventilation. Existing pool tends to get stuffy and hot.</p>	<p>Desire for water polo</p>	<p>The elderly need places where they can do exercises such as walking in the water.</p>	<p>For swimmers with disabilities, hope that scheduling/staff are flexible/compassionate to help adapt to users' needs</p>	<p>Online registration for lessons can be a barrier for people to sign up – very high demand</p>	<p>Likes creating a continuous park walk, since many people, especially seniors, enjoy walking around the park; Also strengthen walking connections between the park areas either side of Colma Creek</p>		<p>Improved acoustics and air quality for an indoor pool</p>	<p>More lap swimming during the day</p>	<p>Likes Mitchell Park and Mitchell Library in Palo Alto</p>
<p>Provide a cooler pool - lap swimming</p>	<p>Add sloped entrance for teaching pool so people with different abilities will be able to use the pool.</p>	<p>Each pool should have a different temperature</p>	<p>50M pool with an operable roof</p>	<p>Humidity control is critical – sufficient ventilation, and/or operable windows</p>		<p>Natural air, some sort of hanger style doors.</p>	<p>Sports can be intense in the area, desire for a place for fun sports like water basketball and volleyball</p>	<p>Warm water pool (seniors are more apt to get cold)</p>	<p>Jodi has autism, and does better when the pool is emptier. A lifeguard once took their break and cleared the pool, then got in the pool with Jodi to swim with/assist her while the pool was otherwise vacated.</p>	<p>Increased number of swim lessons at the same affordable price</p>	<p>Interested in increasing safety of existing crosswalk between existing Aquatic Center and the parking area on the other side of Tennis Drive, potentially by slowing vehicles entering park, adjusting the fence to increase visibility of pedestrians approaching crosswalk, or other measures</p>		<p>Desire for healthy snacks in the vending machines</p>	<p>Think about how the high school(s) could use the pools</p>	<p>Still need a family pool – look at Newark</p>
<p>At a minimum there should be 6 lanes – ideally 8 lanes</p>	<p>Zero depth entrance for instructional pool</p>	<p>Both pools should be indoors – it's too cold and windy and there would be too many leaves blowing into the pools</p>	<p>Provide Olympic size pool—put SSF on the map for swimming.</p>	<p>Hooks in shower areas for hanging toiletries/caddies.</p>		<p>Staff breakroom</p>	<p>Large enough pool to support other Olympic aquatic sports such as water polo and synchro</p>	<p>Warm water for seniors</p>	<p>Desire for sturdy stairs</p>	<p>Offer swim lessons year round</p>	<p>Consider where ice cream truck can park</p>		<p>Ability to purchase sports drinks</p>	<p>Wouldn't support Movie Night use if it displaced demand for use of pools for swimming</p>	<p>The pool at Westmoor High School is a good example of a desirable configuration.</p>
		<p>Wave pool like at</p>		<p>More shower seats. There is often a line</p>		<p>Interested in reservable rentable</p>	<p>Head coach- With new</p>								

Community Favorite



Brink Swimming Pool
City of Pacifica

Community Favorite

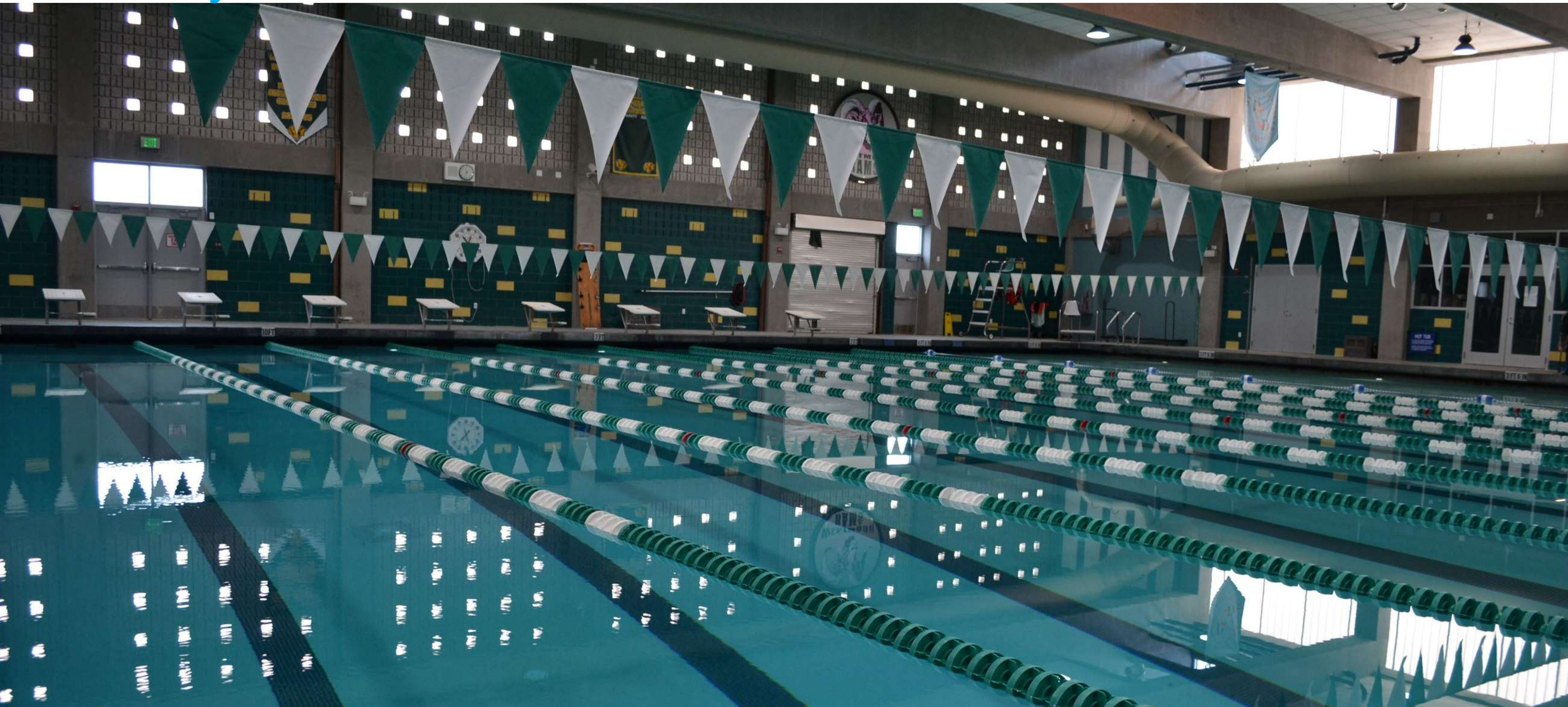

New Giammona Pool
Westmoor High School

Community Favorite

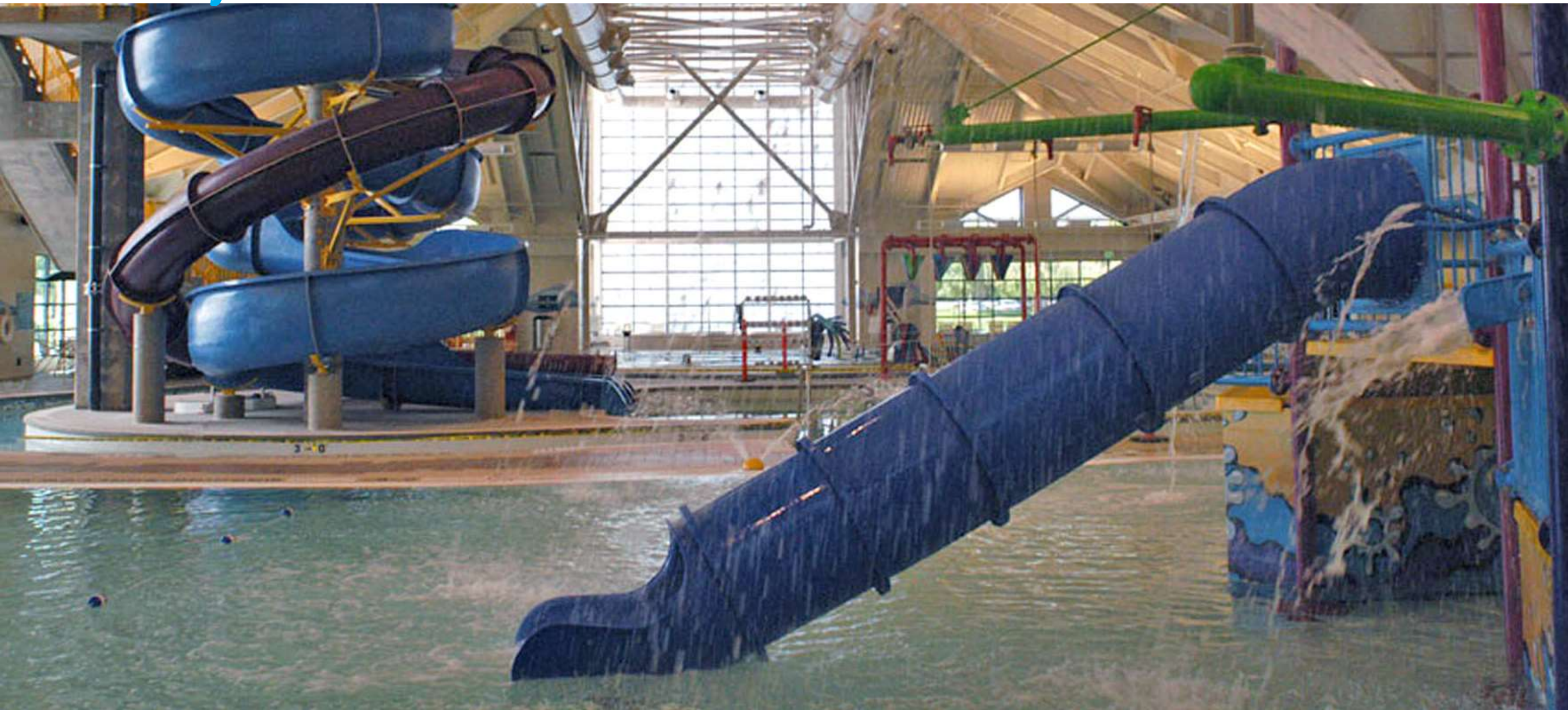

Silliman Aquatic Center
City of Newark

Community Favorite



La Petite Baleen Swim School
San Francisco

Community Favorite



San Ramon Aquatic Center
City of San Ramon

Welcome!
Capital Projects, City of South San Francisco

Orange Memorial Park Pool Workshop Series – Workshop #2

Orange Memorial Park Aquatic Center

A New Community Resource for

The City of South San Francisco
April 30, 2022

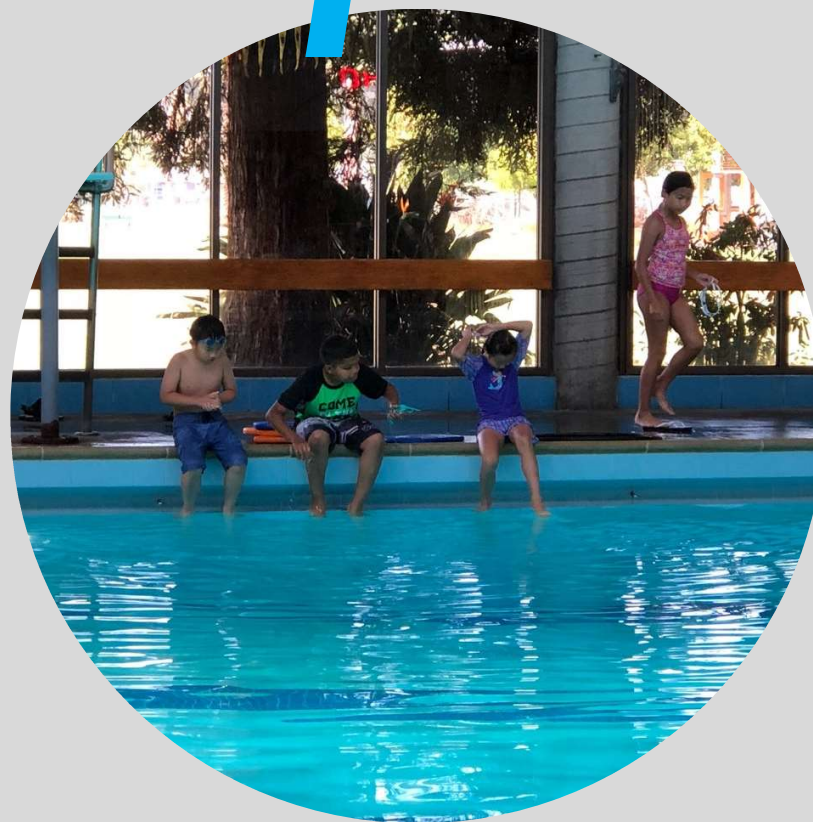

Welcome!

Capital Projects, City of South San Francis

Orange Memorial Park Pool Workshop Series – Workshop #2

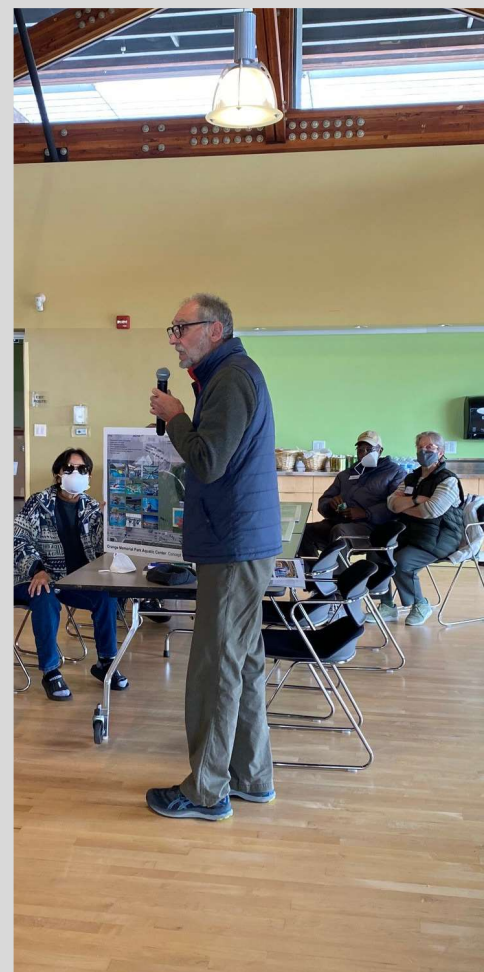

Orange Memorial Park
Aquatic Center

els/

Existing Conditions

- **Components of the existing Orange Pool:**
6 lanes, shallow to deep,
83 degree average water temperature, sauna
- **What works well?**
- **Challenges:** water temperature (too cold and too hot),
not enough lanes for competition, ventilation, ADA, glare,
deck space

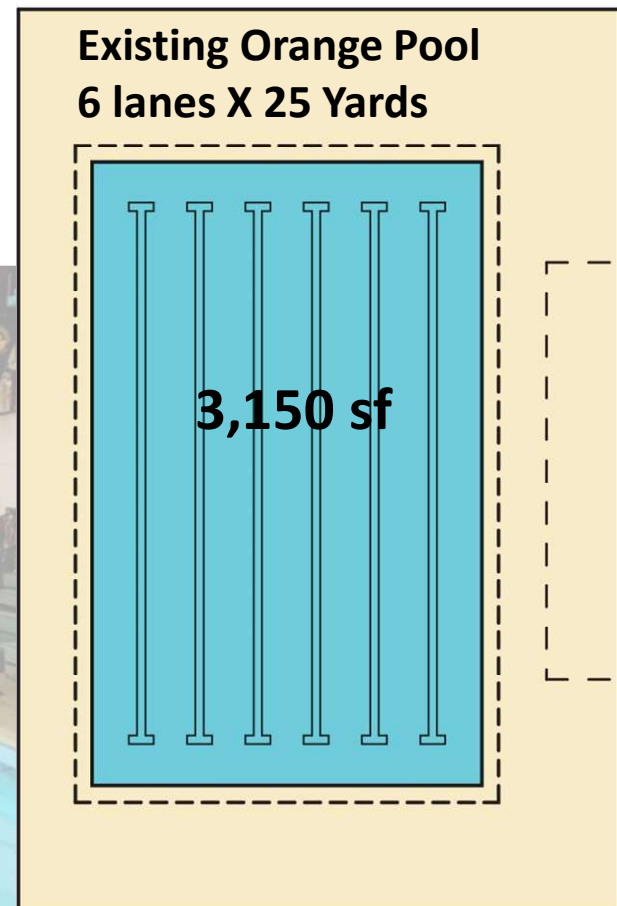

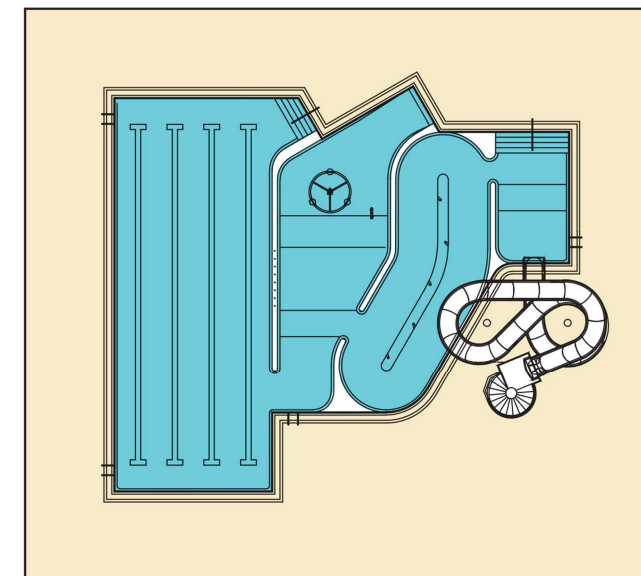
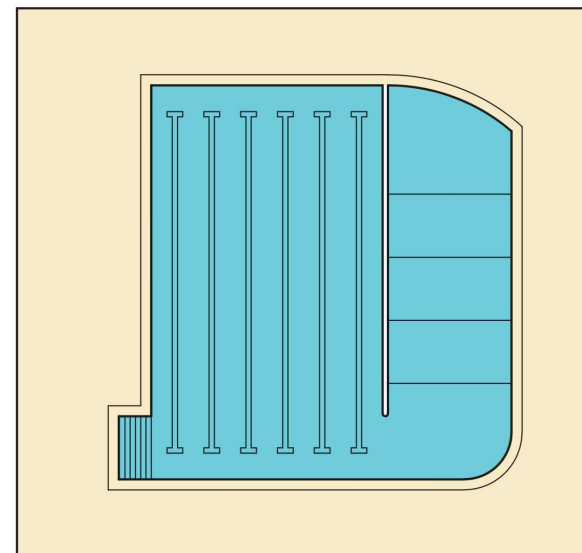
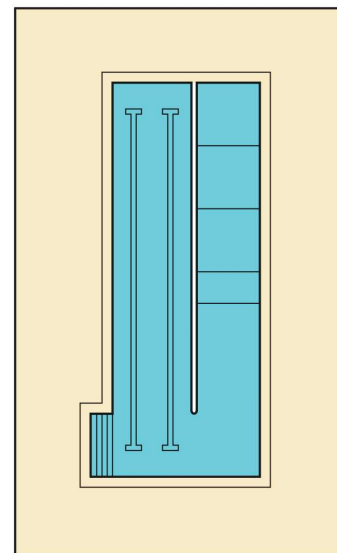
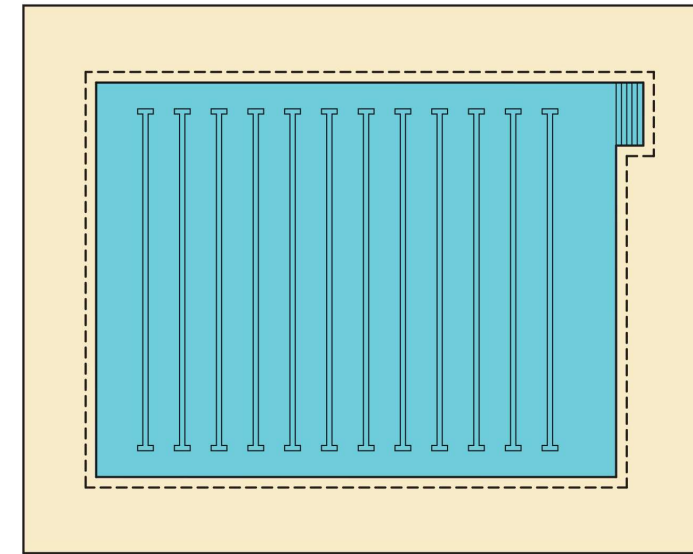
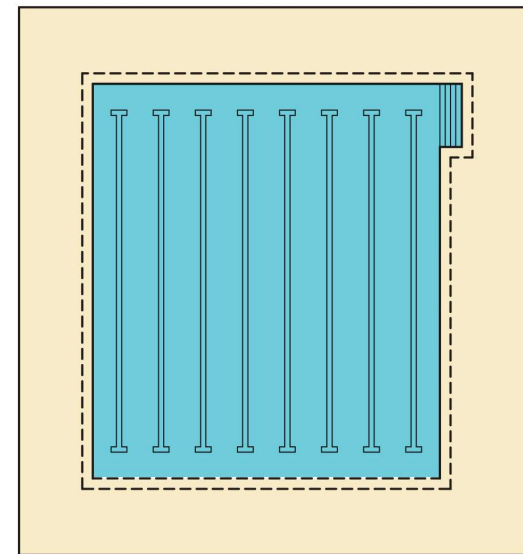
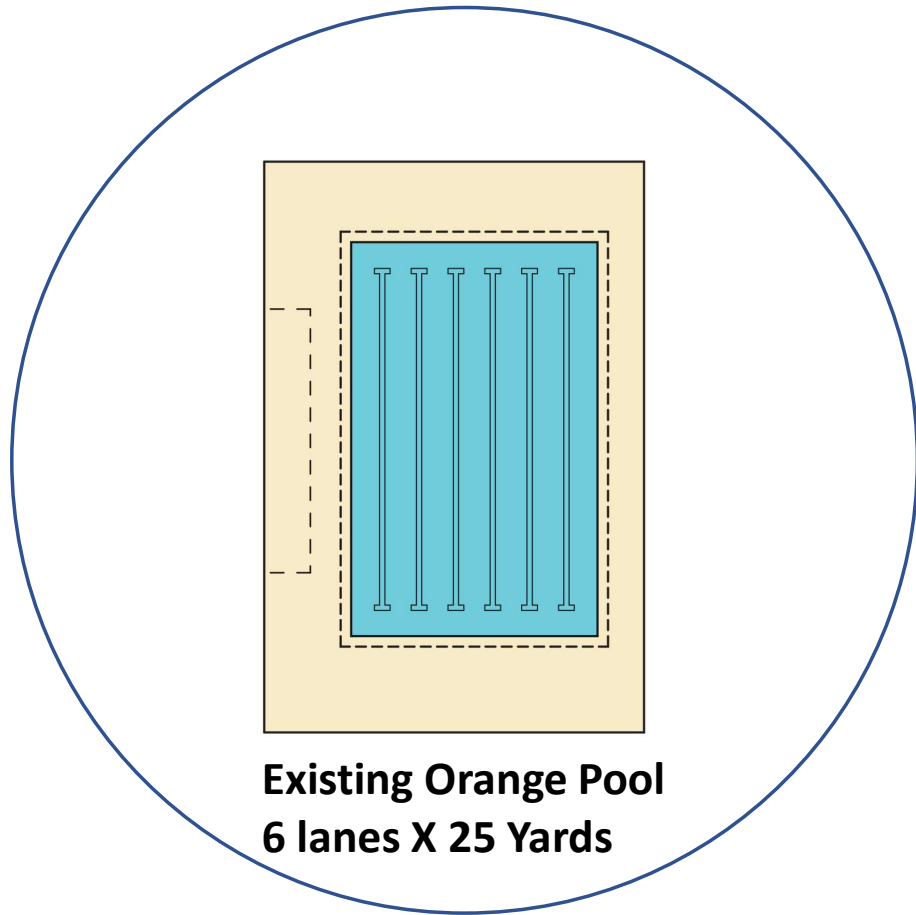







COMPETITION Club + PHS Athletics





PARKING

OR



PARK

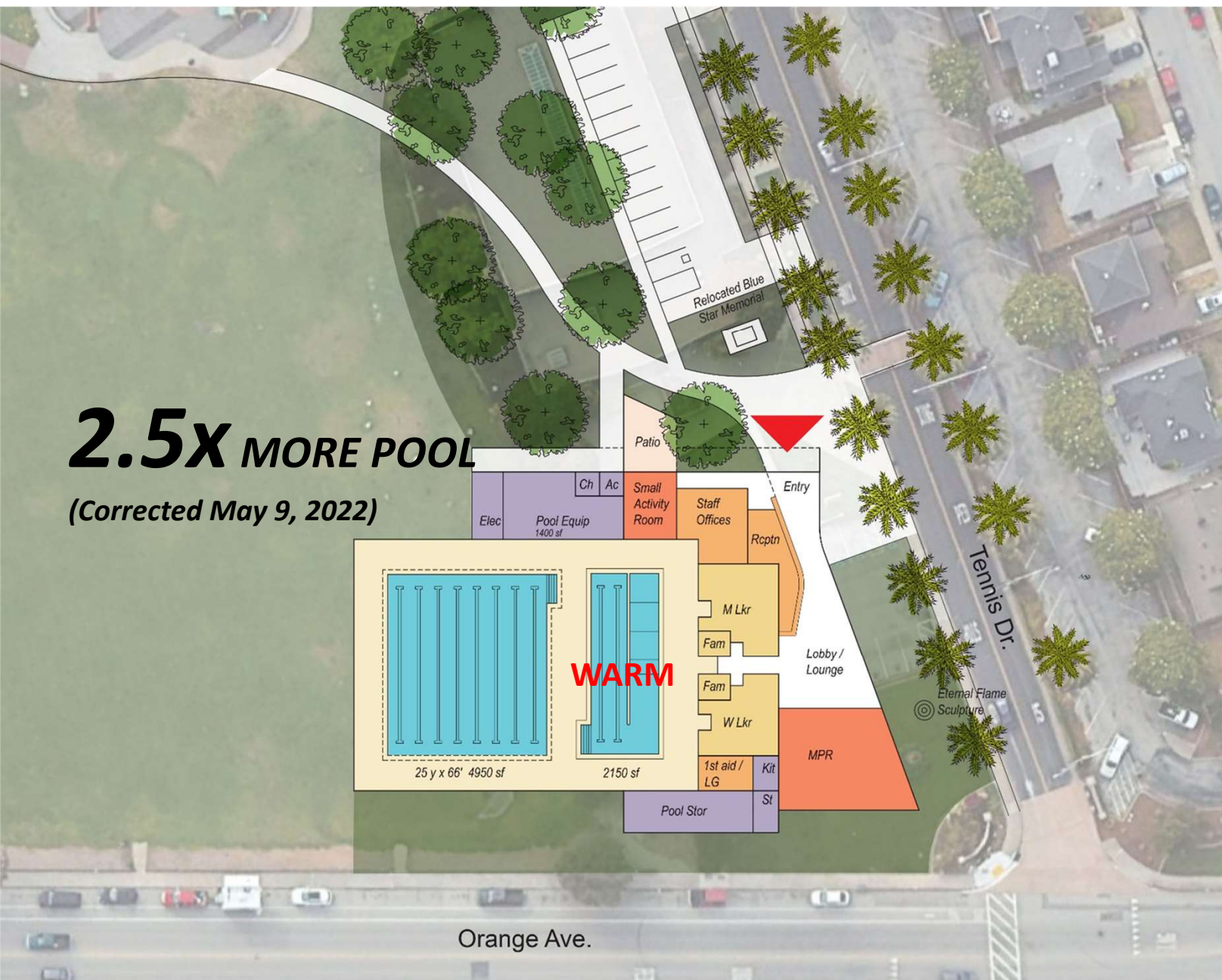

A

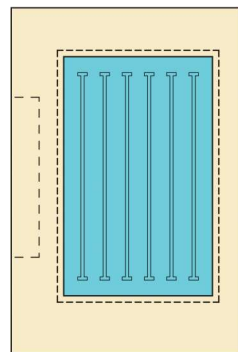

B

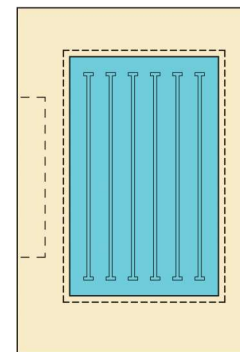

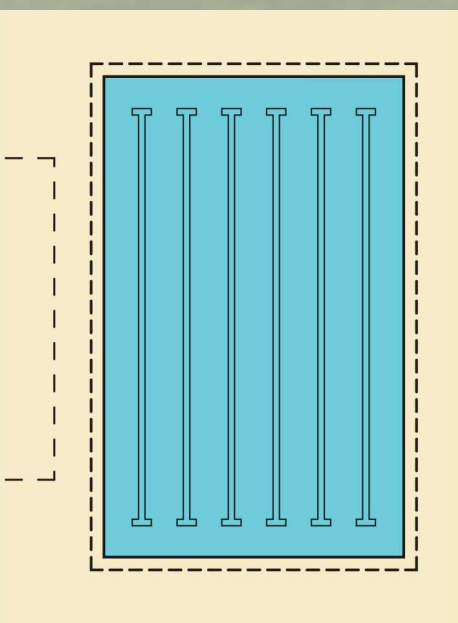

2.5x MORE POOL

(Corrected May 9, 2022)

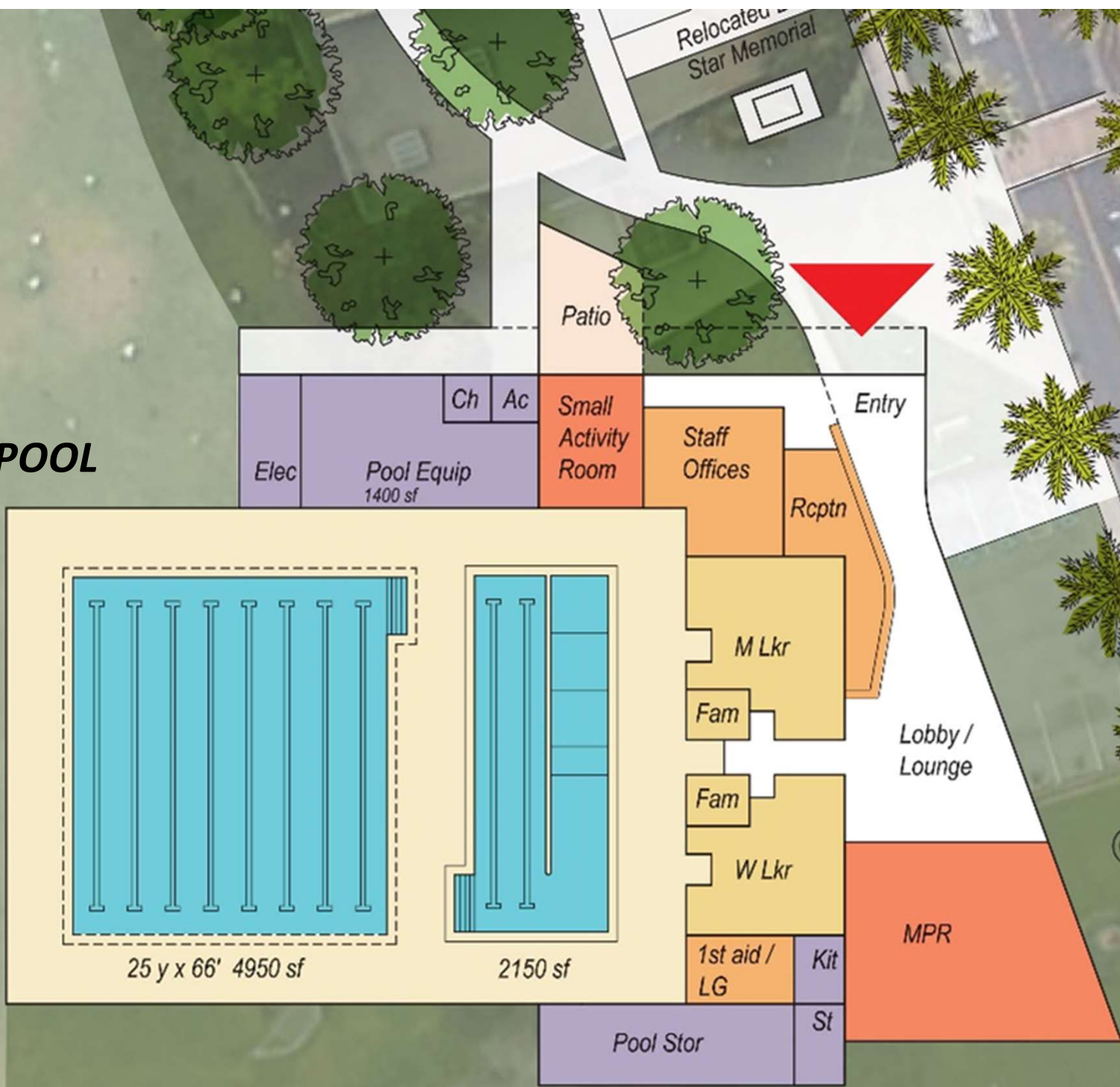

A

Orange Ave.

Tennis Dr.



ENTRY FROM TENNIS

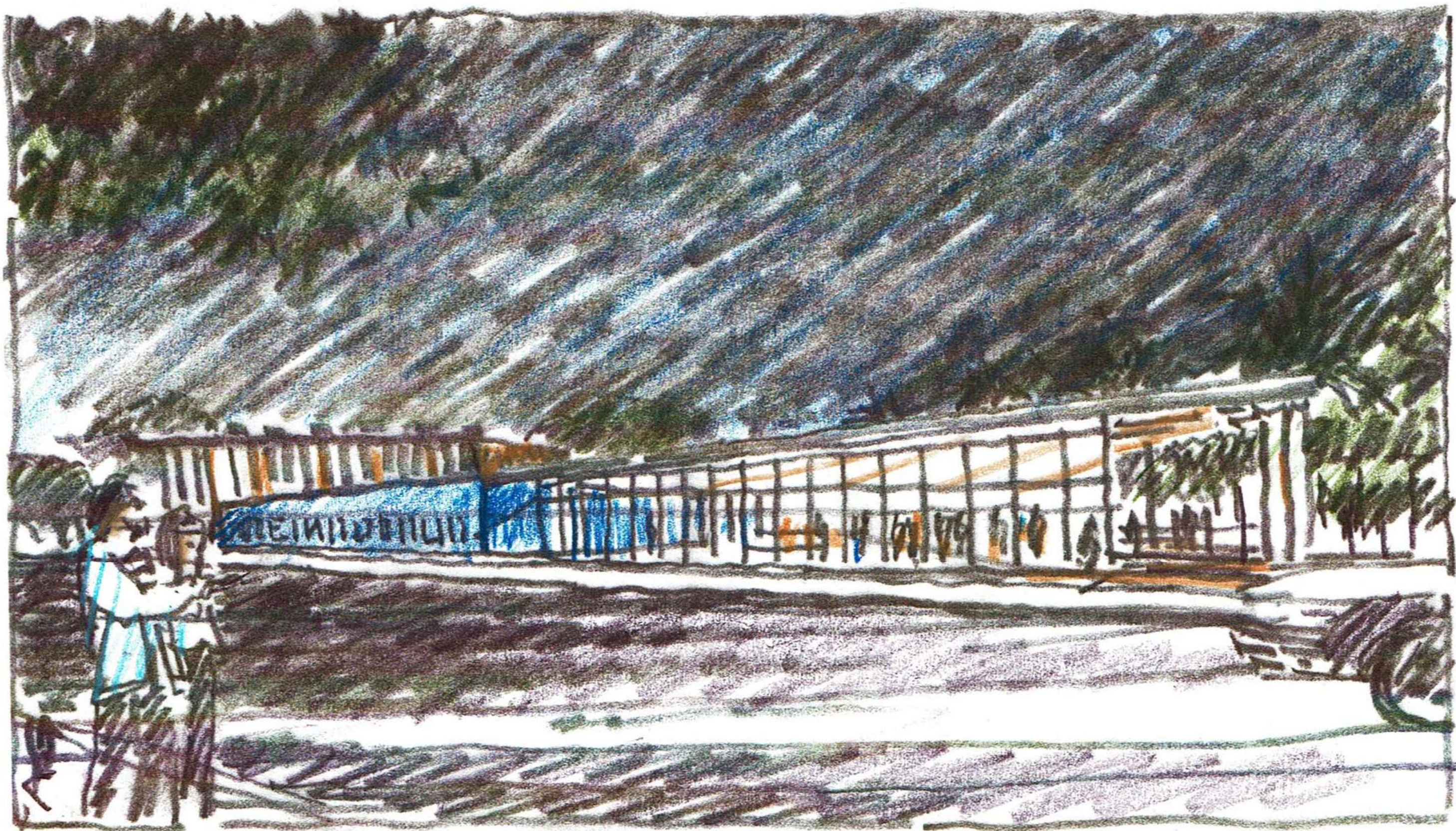

VIEW FROM ORANGE AVENUE

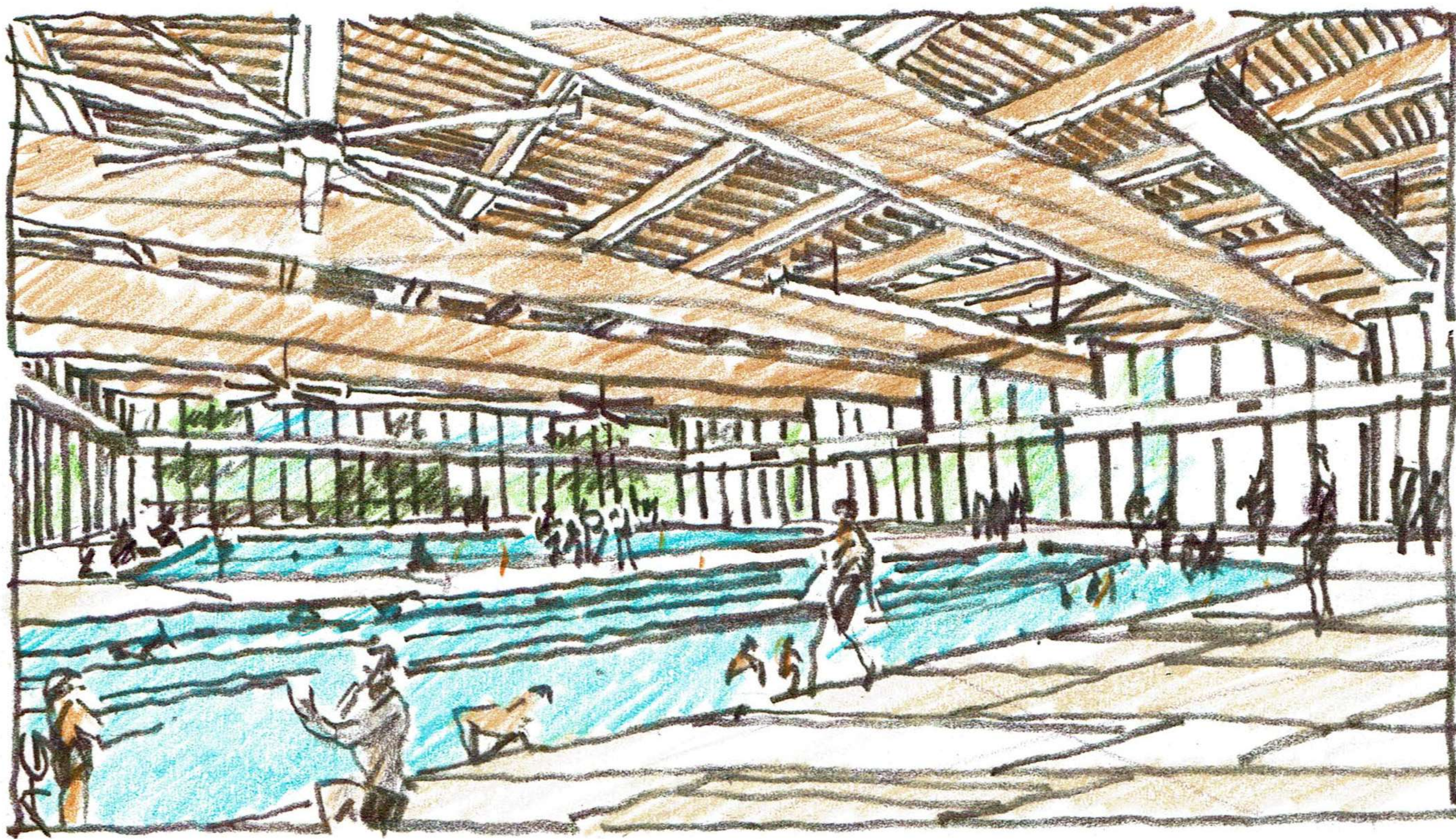

INDOOR POOL

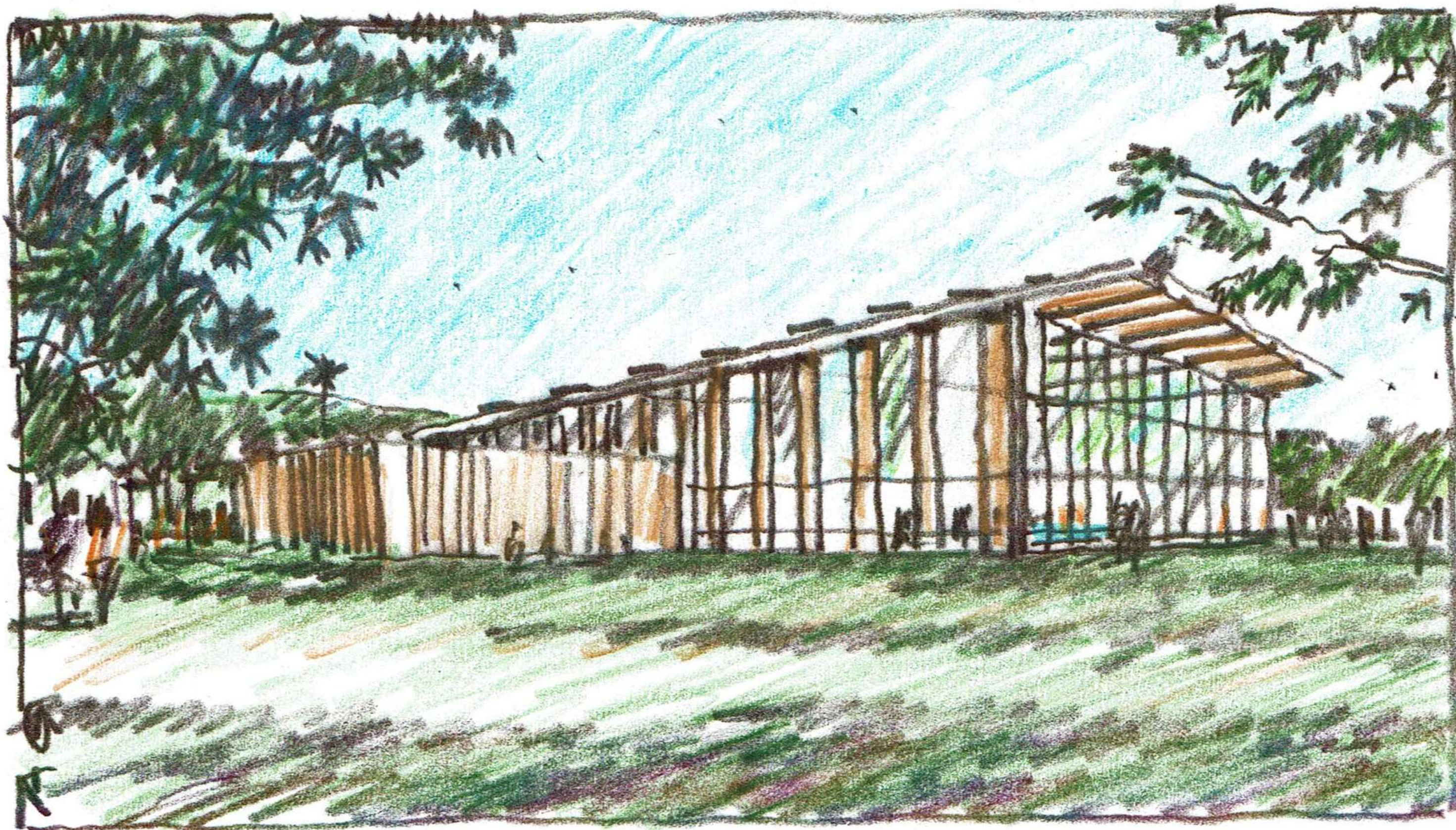

VIEW FROM PARK

B

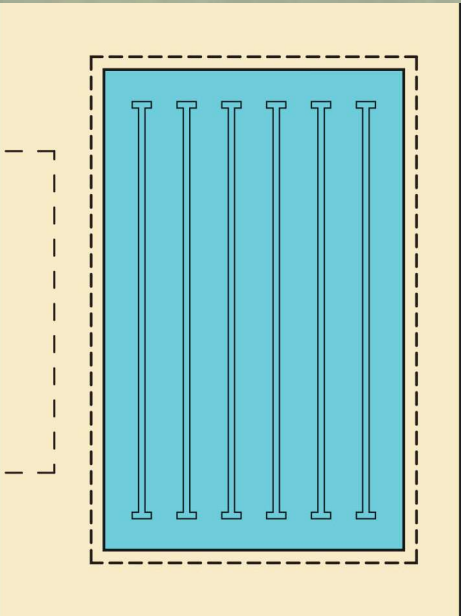

4x MORE POOL
(Corrected May 9, 2022)

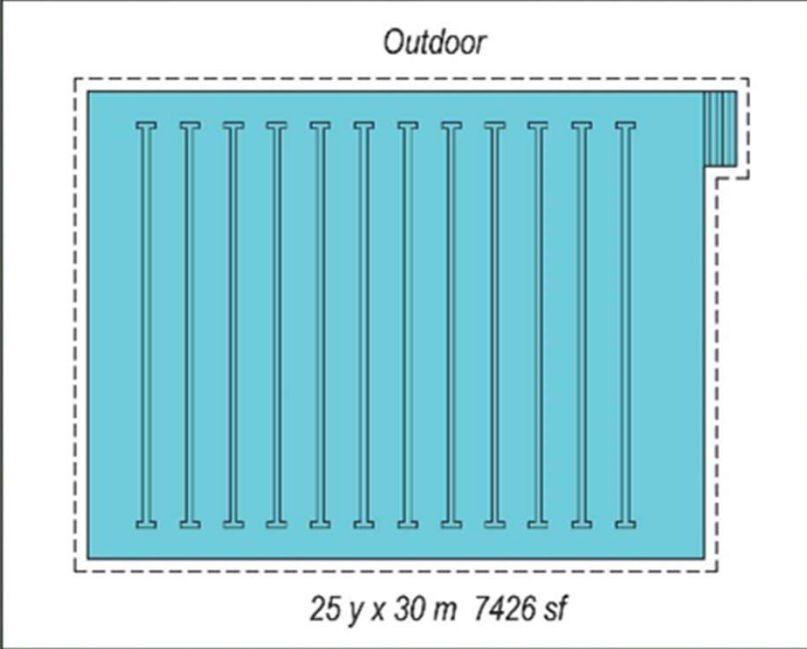

Relocated Blue
Star Memorial

Patio

Entry

Lobby /
Lounge

MPR

1st aid /
LG

Kit

St

Pool Stor

Pool Equip
1800 sf

Ch

Ac

Small
Activity
Room

Staff
Offices

Rcptn

Outdoor

25 y x 30 m 7426 sf

5100 sf

Tennis Dr.

Eternal Flame
Sculpture

Orange Ave.



ENTRY FROM TENNIS

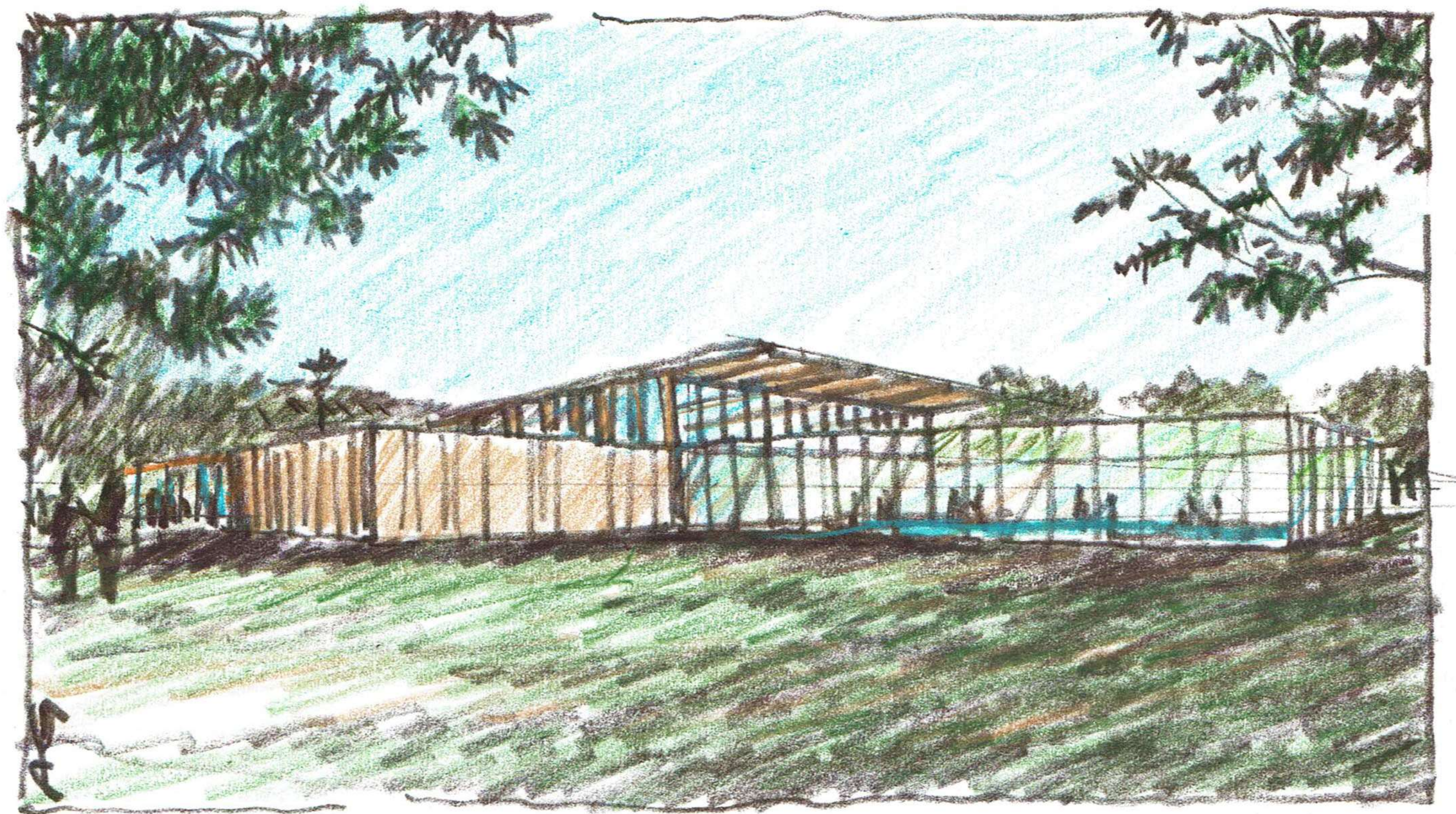

VIEW FROM PARK – OUTDOOR POOL

For Consideration.....

- **Pool location:** Discuss two indoor versus one indoor and one outdoor (same cost as shown). Pros and cons of each.
- **Aquatic features:** swim lanes, starting blocks, slides, zero entry, therapy features, diving boards/platforms, jets/sprays, water-polo, synchronized swimming, bleachers,
- **Building amenities and adjacencies:** locker rooms, swim lounge, multipurpose room, front desk
- **Access/Parking:** how the building is accessed, pick-up/drop-off, parking
- **Other Ideas/Comments**

The New Orange Pool

- Community Workshop 1
COMPLETED
Gallery Walk

April 9, 2022

- Community Workshop #2
Today!
3 Initial Programming Alternatives and Concepts

April 30, 2022

- Community Workshop #3
Preferred Programming and Concept Direction

June 11, 2022

- City Council Presentation – Advance Design
- Design Documents Complete/Bid
- Construction Start
- **SPLASH**

July, 2022

March 2023

May 2023

Spring/Summer2025